



FOR LEASE

JOIN OUR NEWEST TENANT PET SMART NOW OPEN NEW RETAIL PAD SITE FOREST LAKE

107 12th Street Southwest FOREST LAKE, MN

SQUARE FOOTAGE:

1,836 SF - Minimum Divisible
4,239 SF - Max Contiguous

FEATURES

- Immediately off Freeway Exit
- Grocery Anchored Pad in the heart of the Forest Lake Retail
- No Pad Restrictions

AREA TENANTS

Target, Super Wal-Mart, Aldi Foods, Office Max, Northern Tool, Pet Smart, Walgreens, TCF Bank, Cub Foods, Menards, Home Depot, Perkins, Tim Horton's

**FOR MORE INFORMATION
PLEASE CONTACT:**

Josh Bloom
Principal
651.315.7863
josh@bloomcommercial.com

Tim Bloom
Principal
651.319.5011
tim@bloomcommercial.com

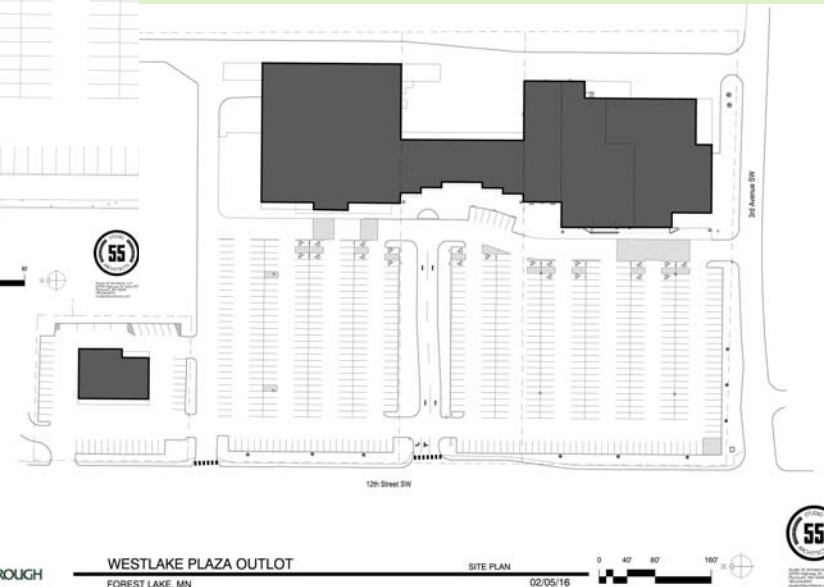
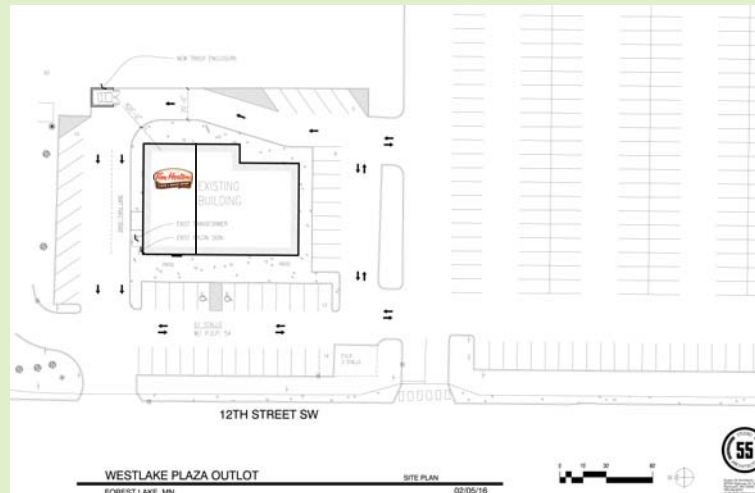

WESTLAKE PLAZA OUTLOT
FOREST LAKE, MN

SITE PLAN
02/05/16



NEW RETAIL PAD SITE FOREST LAKE

107 12th Street Southwest FOREST LAKE, MN



BCRE

bloom commercial real estate



OVERALL WEST ELEVATION REMODEL



WEST ELEVATION

FOR MORE INFORMATION PLEASE CONTACT:

Josh Bloom
Principal
651.315.7863
josh@bloomcommercial.com

Tim Bloom
Principal
651.319.5011
tim@bloomcommercial.com

Bloom Commercial Real Estate
527 Marquette Ave, Suite 500
Minneapolis, MN 55402
www.bloomcommercial.com



EST. DEMOGRAPHICS	1 MILE	3 MILES	5 MILES
Population	4,541	16,327	27,564
Median HH Income	\$56,771	\$75,052	\$78,298
Total Households	2,003	6,395	10,242