



Join our newest Tenant
PETSMART

FOR LEASE

FOREST LAKE - WESTLAKE CENTER

119-289 12th Street S.W. FOREST LAKE, MN

SQUARE FOOTAGE:

9,580 SF

FEATURES

The Forest Lake Community takes much pride in its business community, variety of housing developments, and quality educational options. Forest Lake is also proud of their unique amenities such as beautiful Forest Lake, Castlewood and Tanners Brook Golf Courses and the Municipal airport.

CO-TENANTS

Aldi, Petsmart (NEW Tenant), Office Max, Northern Tool and Equipment, Walgreens, Perkins, Wal-Mart, Cub Foods, Menards

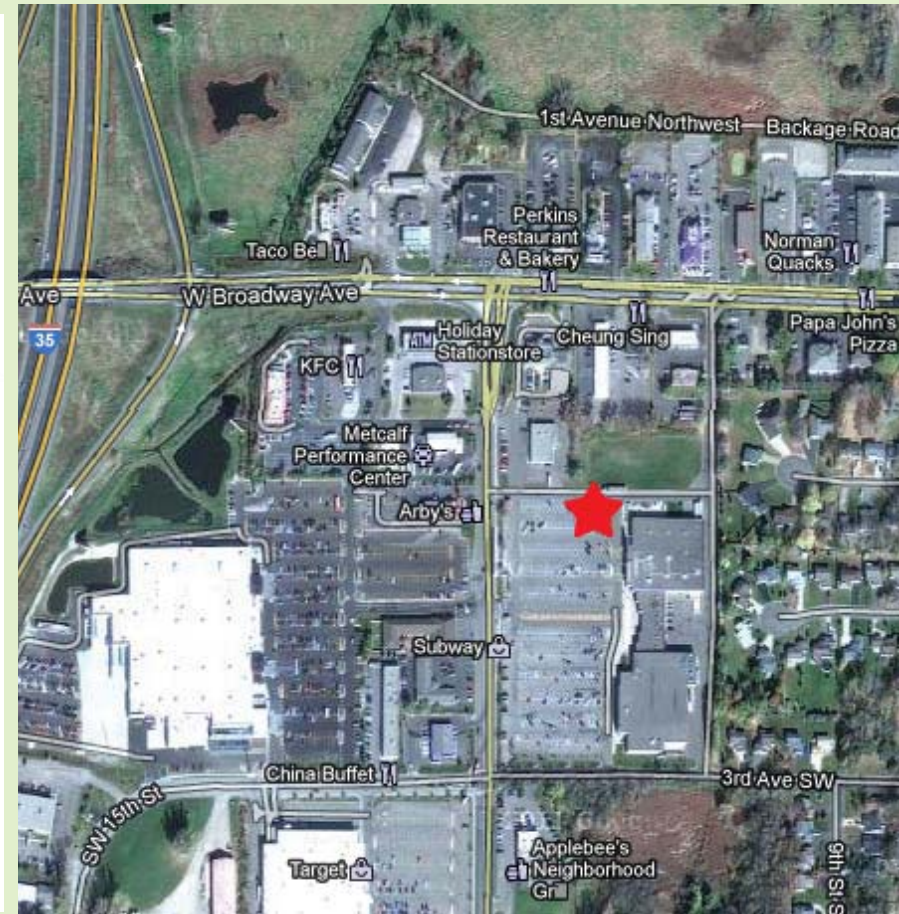
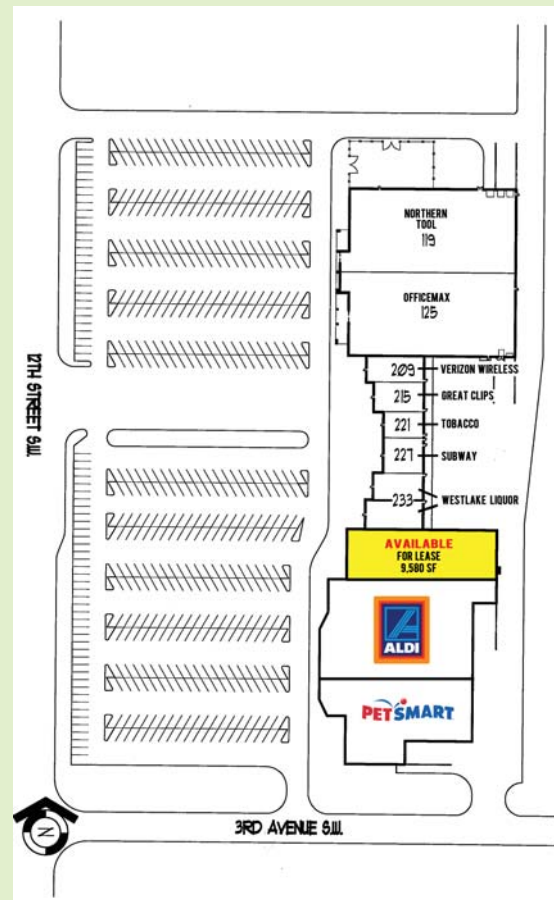

**FOR MORE INFORMATION
PLEASE CONTACT:**

Josh Bloom
Principal
651.315.7863
josh@bloomcommercial.com

Tim Bloom
Principal
651.319.5011
tim@bloomcommercial.com



EST. DEMOGRAPHICS	1 MILE	3 MILES	5 MILES
Population	4,541	16,327	27,564
Median HH Income	\$56,771	\$75,052	\$78,298
Total Households	2,003	6,395	10,242

FOREST LAKE-WESTLAKE CENTER

119-289 12th Street S.W. FOREST LAKE, MN



BCRE

bloom commercial real estate



OVERALL WEST ELEVATION REMODEL



WEST ELEVATION

FOR MORE INFORMATION PLEASE CONTACT:

Josh Bloom
Principal
651.315.7863
josh@bloomcommercial.com

Tim Bloom
Principal
651.319.5011
tim@bloomcommercial.com

Bloom Commercial Real Estate
527 Marquette Ave, Suite 500
Minneapolis, MN 55402
www.bloomcommercial.com



PERSPECTIVE